

VELTEKO

VERTICAL
PACKAGING
MACHINE

HSV 210

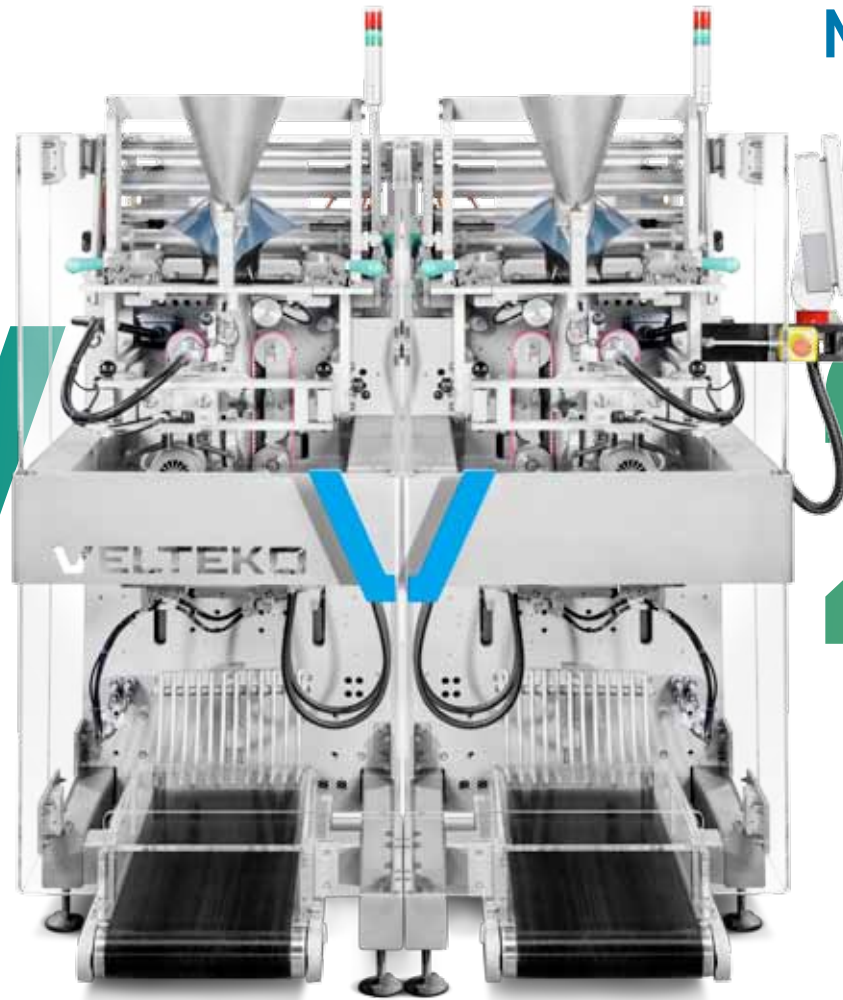

SLIM

The HSV210-SLIM series of vertical packaging machines is specially designed for packaging snacks and small-pieced products into pillow bags. It delivers

THE HIGHEST POSSIBILITY OF OPTIMIZING

all necessary conditions for creating high-quality seals at high speed.



Tight and
good-looking
seals

Maximum speed of
400 bags/min
with the twin version

750 mm
machine width



Ease
of operation

VELTEKO
Dataservice
*Remote communication
with your machine*

Easy
to maintain

Tight and good-looking seals

VELTEKO Powerseal Technology

The special Powerseal mechanism drives the cross sealing jaws, which exert the necessary force to achieve perfect seals with a wide range of films.

VELTEKO motion-controlled jaws

Sophisticated motion control of the simultaneous cross sealing jaws allows for maximum sealing time at high speed.

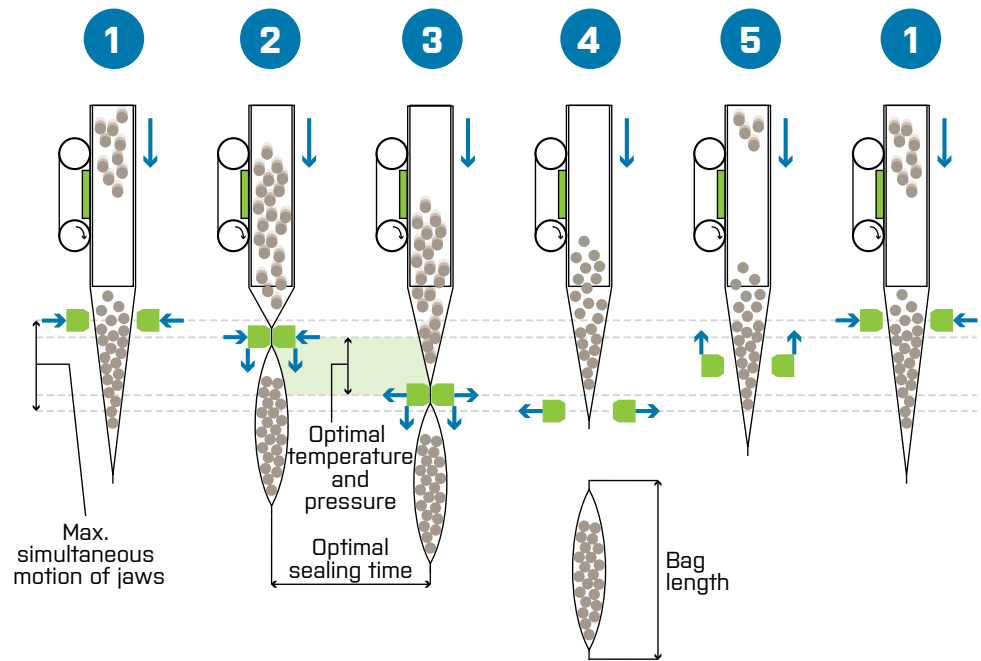

Ease of operation

Human-machine interface

For intuitive setting of the machine's operational parameters.

- ❑ A powerful industrial PC with a large color touch screen.
- ❑ Customizable control via icons or buttons with text descriptions.
- ❑ Assistance in choosing operating parameters.
- ❑ 500 memory settings for operating parameters (programs) with export and backup.
- ❑ Possibility of automatic selection of programs by scanning a barcode.
- ❑ Identification of the machine operator via card or RFID chip.
- ❑ User manual, wiring diagram, etc. can be accessed on the terminal's touch screen.
- ❑ Image Manager - Import, export, and delete images via the terminal and even capture images from the system's camera.
- ❑ Video Manager – Upload and playback of videos.
- ❑ Extensive help section.
- ❑ Dataservice Visual.



VT+ Modules (Versatile Technology Plus)

VT+ modules simplify setup of film unwinding features when changing format and thus reduce demands on the skills of the operator.

- ❑ **Unwinding packaging film** roll automatically adjusts all set operating parameters of the machine.
- ❑ **Position of foil edge sensor and photo cell.** Position adjustable by servomotor. Position setting can be saved to memory.
- ❑ **Positions of film rollers.** For location of print data (label) and for adjusting the entrance angle of the film on the collar. Electronically monitored. Position setting can be saved to memory.



Dials or gauges

All manual equipment comes with dials or gauges to ensure consistent settings.

Pillow bag

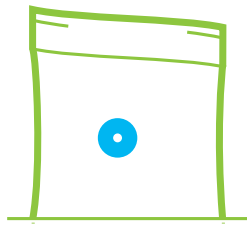
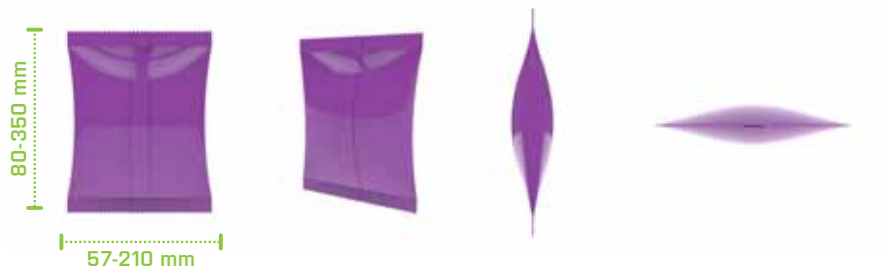

INTERNAL VALVE



LABEL

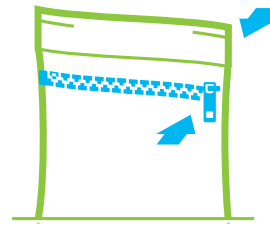

CROSS ZIP



CARRY HANDLE



EUROSLLOT

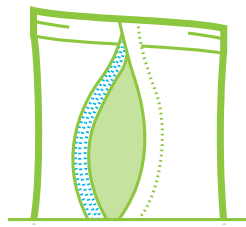

RECLOSABLE FLAP

VELTEKO Dataservice

Dataservice Support

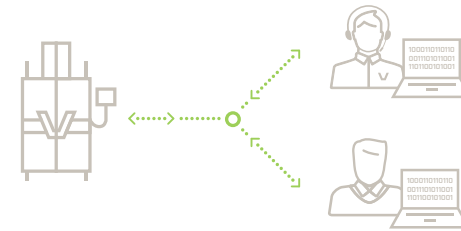

Dataservice Visual



Dataservice OPC



Easy to maintain

- ▣ Dataservice support.
- ▣ Monitoring of service intervals, depending on the type of machine operation.
- ▣ Extensive self-diagnostics and monitoring.
- ▣ Ability to set access rights to individual controls.
- ▣ Sensors with connectors for easy replacement.
- ▣ Interactive manual and spare parts catalogue for each specific machine configuration.
- ▣ Automatic check for pneumatic leaks.
- ▣ Support from VELTEKO's Service Center.

750 mm machine width

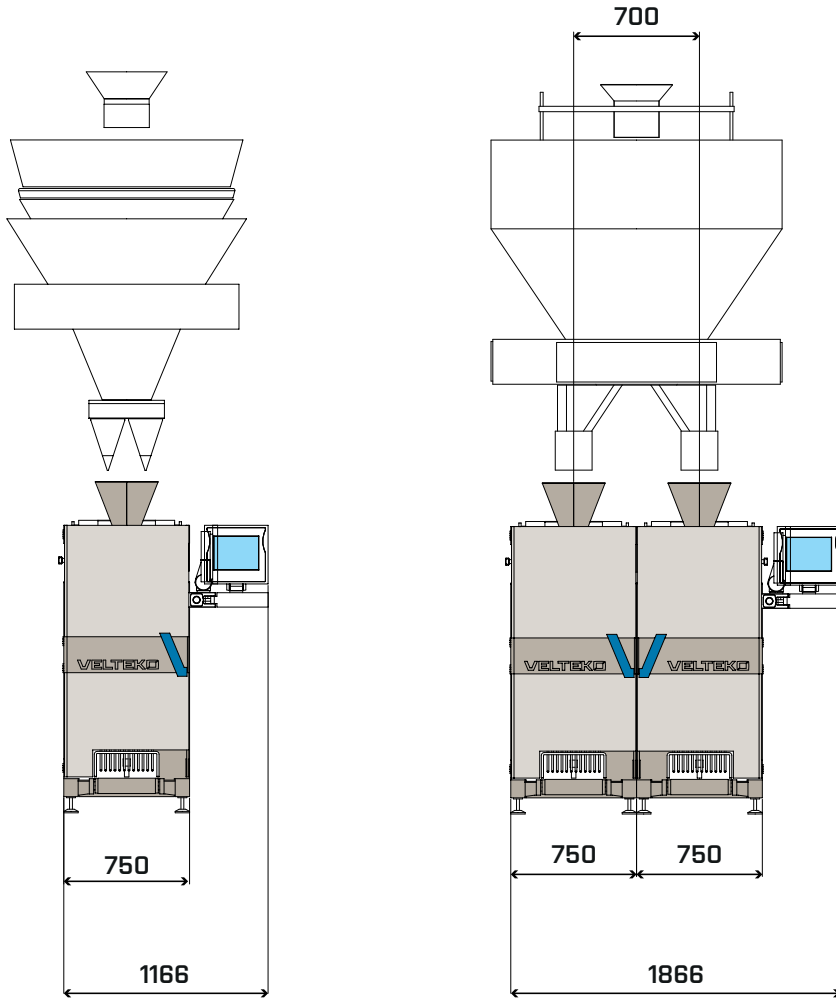

HSV210-SLIM

HSV210-SLIM-TWIN

Technical Parameters

	HSV210-SLIM	HSV210-SLIM-TWIN
Operating Mode	3-axis continuous	2 x 3-axis continuous
Speed	up to 200 bags/min	up to 400 bags/min
Max. dimension of cross seal		210mm
Max. film width		440mm
Electricity	3 x 400 V / 50 Hz	
Air pressure	0.6 MPa	

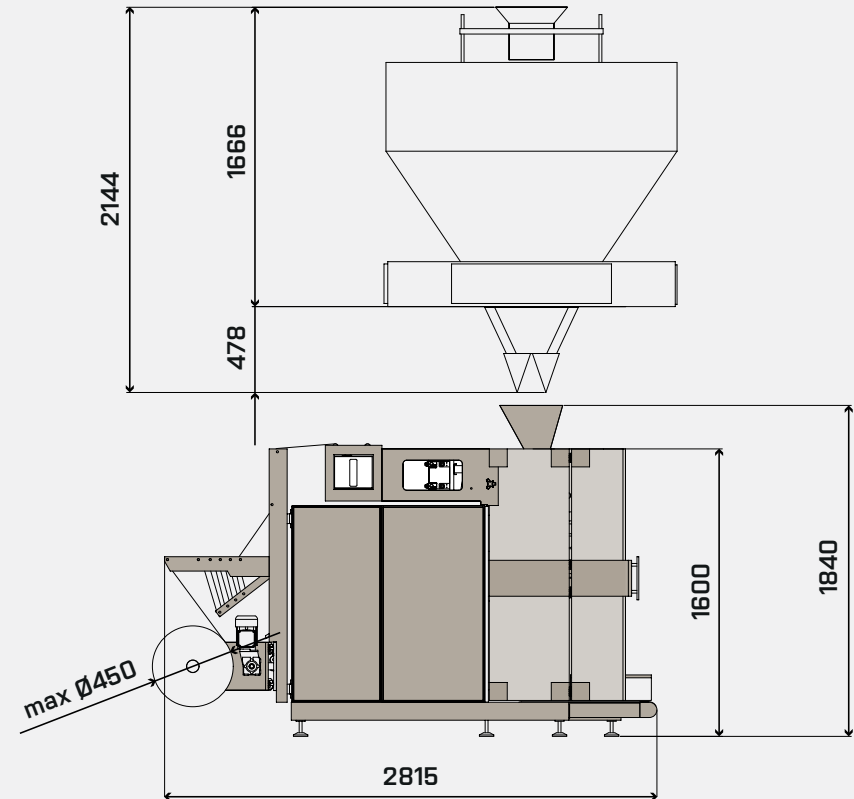

Contacts

VELTEKO CZ s.r.o.
K Borovičkám 1716
258 01 Vlašim
Czech Republic
Tel. +420 317 846 473
velteko@velteko.cz

VELTEKO POLSKA Sp. z o. o.
Ul. Św. Michała 43
61-119 Poznań
Poland
Tel. + 48 61 650 34 07
velteko@velteko.pl

ООО «ВЕЛТЕКО РУС»
4-ая Тверская-Ямская, д. 33/39
125047 г. Москва
Russia
Тел. +7 495 799 93 78
velteko@velteko.ru

GLOBAL SALES NETWORK

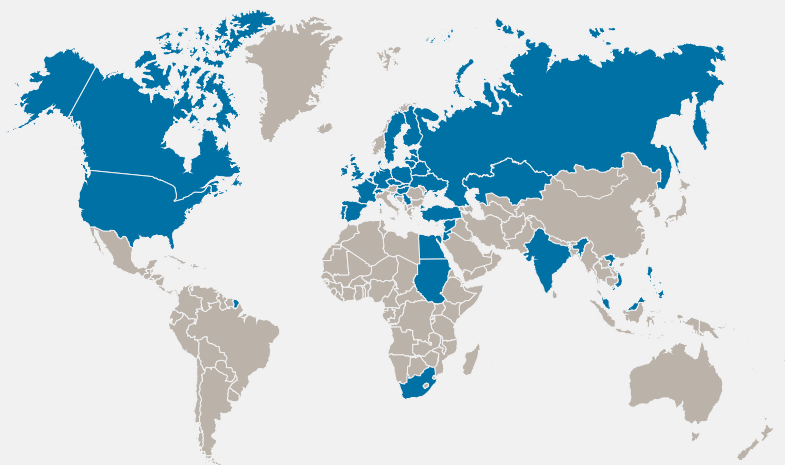

MARKETS WHERE YOU CAN FIND VELTEKO DISTRIBUTORS

Your VELTEKO distributor

www.velteko.com

The contents of this catalog are not an offer for a contract, a promise to conclude a contract nor any legal proceedings by VELTEKO s.r.o. regardless of its content or denominations. VELTEKO s.r.o. reserves the right to change the specifications of machines that are illustrated and described in this catalog. Photos of machines are for informational purposes only and may contain optional accessories. Please contact your local distributor to receive an offer that is tailored to your requirements.

More machines from our portfolio

HSV280B

- One machine for more than 100 different variations of bags
- Maximum speed of 200 bags/min
- 5 – 45 min. changeovers to a different bag type
- More than 16 variations of standup pouches
- Max. dimension of cross seal 280 mm



HSV360A-DUPLEX

- Maximum speed of 360 pillow or three-side sealed bags per minute
- Double tube design



VELTEKO – The vertical packaging machine experts